

## Plastic Reed Switches Series

### Introduction

The PCB series is a molded dry reed switch. It is designed for PCB mounting and available in lead, DIP or SMD configuration, sealing design, suit to tough environment, water-proof and shock-proof, long service life at least 10 million times, customer can choose different specifications according to different working environment.



### Features

- Box or tape&reel packaging optional
- Variety of AT range
- Ideal for PCB pick and place.
- switching distance dependent on magnet

### Applications

- Automobile、 industry control
- Fitness equipment
- Pulse Counter
- Security alarms sensor

### Dimensions

1、 Lead Type

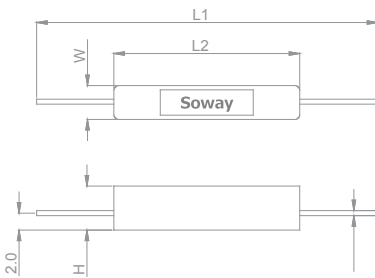

2、 DIP Type

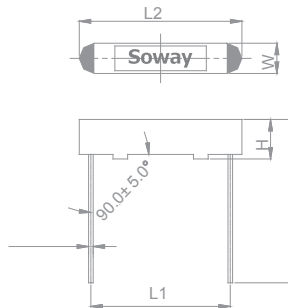

3、 SMD Type

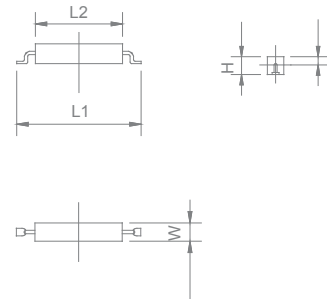

### Example of Permanent Magnet Operating Characteristics

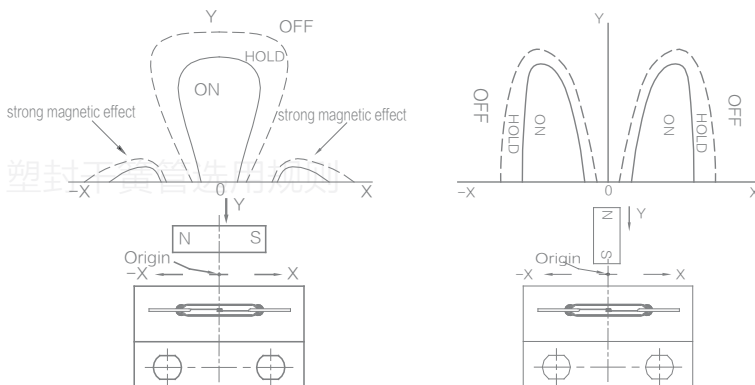

### Packaging

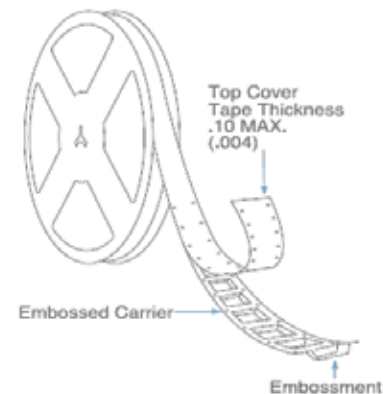

## Electrical Parameters

Electrical parameters						
Model	RS-90 series	RS10 series	RS/RM-01C series		RS/RM-48 series	
Pull in AT range	15-40	7-21	7-19	16-25	15-28	24-51
Switch power(max)	5W	10W	10W	10W	70W	70W
Switch voltage DC ( max )	175V	200V	180V	200V	200V	200V
Switch voltage AC ( max )	140V	140V	130V	140V	250V	250V
Switch current DC ( max )	350mA	500mA	250mA	500mA	1000mA	1000mA
Switch current AC ( max )	250mA	500mA	250mA	500mA	1000mA	1000mA
Breakdown voltage(mini)	180V DC	200-230V DC	180V DC	230V DC	400V DC	580V DC
Carry current(max)	0.5A	0.5A	1.5A	1.75A	1.75A	2.25A
Contact resistance(max)	160mΩ	150mΩ	100mΩ	100mΩ	90mΩ	90mΩ
Insulation resistance(min)	10 <sup>6</sup> MΩ	10 <sup>6</sup> MΩ	10 <sup>6</sup> MΩ	10 <sup>6</sup> MΩ	10 <sup>6</sup> MΩ	10 <sup>6</sup> MΩ
Operating temperature	-40°C~+80°C	-40°C~+80°C	-40°C~+80°C	-40°C~+80°C	-40°C~+80°C	-40°C~+80°C

Note: customized specific requirements

## Ordering Guide

	<input type="checkbox"/>	-	<input type="checkbox"/>	<input type="checkbox"/>	<input type="checkbox"/>	<input type="checkbox"/>	<input type="checkbox"/>	<input type="checkbox"/>	<input type="checkbox"/>	Selection tables
Reed Switch Type	RS									Leaded
	RM									Staple Form
	RS10									Gull Wing
Reed Switch Dimension		X	X	X						Reed Switch Selection Table
Pull In AT Range					X	X	X			
Sensing Distance ( Reserve )								X	X	

## Plastic Reed Switch Ordering Guide

**1、Lead Type** Unit: mm

Model	Dimension ( Square )			
	L1	L2	W	H
RS-02	46.0	11.5	2.4	2.6
RS-01C	46.0	15.0	3.2	3.2
RS-48	46.0	22.0	4.0	5.2
RS-90	46.0	22.0	4.0	5.2

**2、DIP Type** Unit: mm

Model	Dimension ( Square )			
	L1	L2	W	H
RM-02	15.24	17.78	3.3	4.32
RM-01C	20.32	22.86	4.32	4.32
RM-48	25.4	28.5	6.1	5.28
RM-90	25.4	28.5	6.1	5.28

**3、SMD Type** Unit: mm

Model	Dimension ( Square )			
	L1	L2	W	H
RS10-G1	16.4	11.5	2.4	2.6
RS10-G4	19.6	11.5	2.4	2.6
RS10-G7	15.3	11.5	2.4	2.6

\*SMT or Manual operation should be confirm before order

Selection example: **RS-01CSOA**  
 Leaded, body length 15mm, Normally open, Power 10W,AT range 7-10 plastic reed switch.

